

## Exercise no 10

**New commands and operations:** creating a drawing template, Design Center, data extracting, tables, dimension styles.

1. Open new drawing using ACADISO.DWT template.
2. Create the following layers:

WOODWORK	BLUE COLOUR	CONTINUOUS LINE	0.25 MM
FLOOR	WHITE COLOUR	CONTINUOUS LINE	0.25 MM
FURNITURE	YELLOW COLOUR	CONTINUOUS LINE	0.25 MM
PLANTS	GREEN COLOUR	CONTINUOUS LINE	0.15 MM
DIMENSIONS	WHITE COLOUR	CONTINUOUS LINE	0.15 MM

3. In paper space prepare drawing for printout as a pdf file: sheet size A3, print style MONOCHROM.CTB. Insert block A3\_EN\_L with drawing frame and table. Save the picture as template file: LOGIN.DWT. Close drawing.
4. Open new drawing using LOGIN.DWT template.
5. Using ATTACH command add a reference to the file OFFICE\_WALLS.DWG containing exterior walls without windows and doors at 0.0. Set proper drawing scale in paper space. Verify and complete the data in the table.
6. On the WOODWORK layer insert dynamic blocks of doors and windows defined during the previous exercise. Define appropriate attribute data.
7. Insert dynamic blocks of tables on the FURNITURE layer and other furniture blocks from Design Center (CTRL+2) with the scale 0.1.
8. On the FLOOR layer insert block FIREPLACE.DWG containing fireplace. Draw flooring tiles (30 by 30 cm) in the vicinity of fireplace according to the picture on the reverse. Create an oval viewport presenting fireplace detail in 1:20 scale.
9. On the PLANTS layer insert blocks of flowers. Blocks are in the Design Center or in subject's website.
10. Pick annotative dimensioning style. Modify dimension style. In SYMBOLS AND ARROWS tab set arrowheads as OBLIQUE. In LINES TAB set EXTEND BEYOND DIM LINES to 1.5. Dimension the drawing in both viewports selecting appropriate scale.
11. Create window and door breakdown table using automatic data extraction (TABLE). When selecting rows, as in Excel, you may change the font size in the properties. Using the bottom right triangular handle, you may change the size of the table.
12. Save the drawing file to disc. Preview the printout and print the drawing to a pdf file.

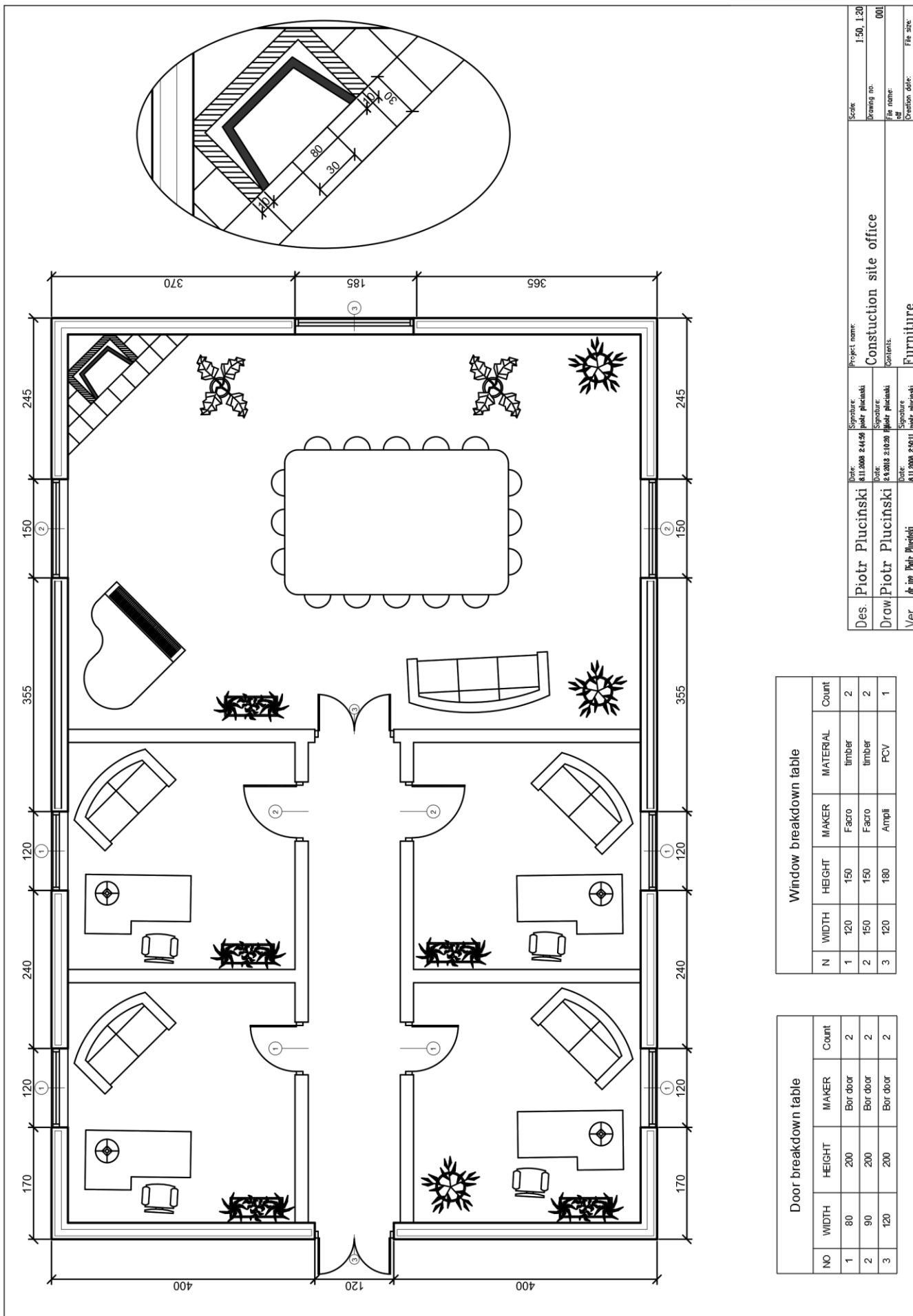

Project name:	Scale:	1:50, 1:20
Des. Piotr Płucinski	Drawing no.	001
Drow Piotr Płucinski	File name:	
Ver. dr inż. Piotr Płucinski	Creation date:	03.2010 2:03:20 PM
Date: 03.11.2008 2:44:56	Signature:	
Date: 03.2010 2:03:20	Signature:	
Date: 03.11.2008 2:50:11	Signature:	
Project name:		Furniture
Construction site office		

N	WIDTH	HEIGHT	MAKER	MATERIAL	Count
1	120	150	Facro	timber	2
2	150	150	Facro	timber	2
3	120	180	Ampil	PCV	1

NO	WIDTH	HEIGHT	MAKER	Count
1	80	200	Bor door	2
2	90	200	Bor door	2
3	120	200	Bor door	2